

KEY FEATURES

- ❖ Fully supports CoaXPress standard with high speed downlink and low speed uplink
- ❖ Supports all high speed bit rates – 1.25G, 2.5G, 3.125G, 5G, 6.25Gb/s, 10Gb/s and 12.5Gb/s
- ❖ Supports PoCXP function to supply power to camera and receive power from grabber
- ❖ Transparent operation – plug and play with no configuration required
- ❖ Extends link distance up to 10km or longer if needed
- ❖ Standard Micro-BNC connector
- ❖ Standard LC duplex fiber interface with optional 1-fiber bi-directional connection
- ❖ Available with extended operating temperature
- ❖ Accepts wide range of DC input 10V~24V DC
- ❖ Power connector with secure locking mechanism
- ❖ LED indicators for operating status
- ❖ Compact size – 72L x 62W x 18H mm

TARGET APPLICATIONS

- ❖ Solar panel or glass panel inspection
- ❖ Semiconductor wafer inspection
- ❖ High speed printing inspection
- ❖ High precision surface inspection (e.g. airplane surface or automobile painting)
- ❖ Automated product inspection (e.g. food, drinking or pharmaceutical products)
- ❖ High resolution and real-time analysis for science, sports, automobile tests, and 3-D animation.
- ❖ High precision security surveillance (e.g. border control, airport)
- ❖ Traffic surveillance/control and vehicle license plate reading/recording (e.g. toll booth)
- ❖ Cameras placed in harsh environment (e.g. nuclear plant, steel mill or undersea monitoring) Other machine vision applications

PHRONTIER™
TECHNOLOGIES

PHORTE™

Single Channel CoaXPress 2.0 Fiber Extender

PHE1-x



Phrontier Technologies, LLC
www.phrontier-tech.com
sales@phrontier-tech.com
Toll Free: 1-866-389-2829
Fax: 1-801-998-1855

TYPICAL SET UP DIAGRAM

PHE1 with 1ch CXP system

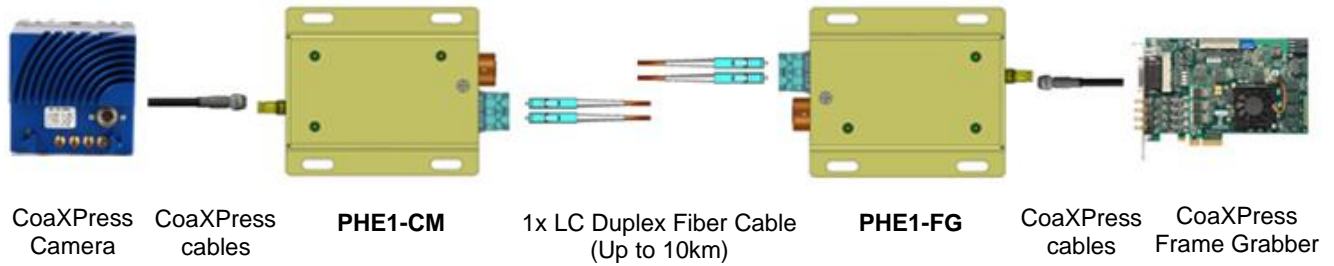

PHE1 TECHNICAL SPECIFICATIONS

General Specification – PHE1

| | | |
|--|---------|---------------------------|
| Storage Temperature | | -40 ~ 85 °C |
| Standard Operating Temperature Without PoCXP | Ambient | 0 ~ 50 °C |
| | Case | 0 ~ 65 °C |
| Operating Humidity | | 20 ~ 80% (non-condensing) |
| Input Voltage | | DC 10 ~ 24 V |
| Typical Supply Current Per Module @24V ^{*1} | | 0.062 A |
| Typical Power Consumption Per Module ^{*1} | | 1.5 W |
| Power Connector on Module | | Binder 09-0982-00-04 |
| Approx. Weight (each module) | | 67 gram |

^{*1} Measurements are done with PHE1-M @ 25C and PoCXP is switched off.

CoaXPress Interface – PHE1

| | |
|----------------------|---|
| Downlink Data Rate | CXP-1, CXP-2, CXP-3, CXP-5, CXP-6, CXP-10, CXP-12 |
| Uplink Data Rate | 20.83 Mb/s, 41.67Mb/s |
| Connector | Micro-BNC |
| PoCXP Output Voltage | 24 V |
| PoCXP Supply Power | 17W/Ch |

Optical Interface – PHE1

| | PHE1-M | PHE1-S | PHE1-B |
|---|-----------|-----------|--------------------------------|
| Operating Wavelength | 850nm | 1310nm | CM Tx: 1270nm FG Tx: 1330nm |
| Min Optical Tx Output Power ^{*2} | -5 dBm | -7 dBm | -7 dBm |
| Min Optical Rx Power ^{*2} | -10.3 dBm | -12 dBm | -12 dBm |
| Max Optical Rx Input Power ^{*2} | 2.4 dBm | 2.5 dBm | 2.5 dBm |
| Connector Type | LC duplex | LC duplex | LC simplex |
| Fiber Type | MM | SM | SM |

^{*2} Optical power is measured in average power. More optical power options are available upon requests

PHE1-x MECHANICAL INFORMATION (mm [inch])

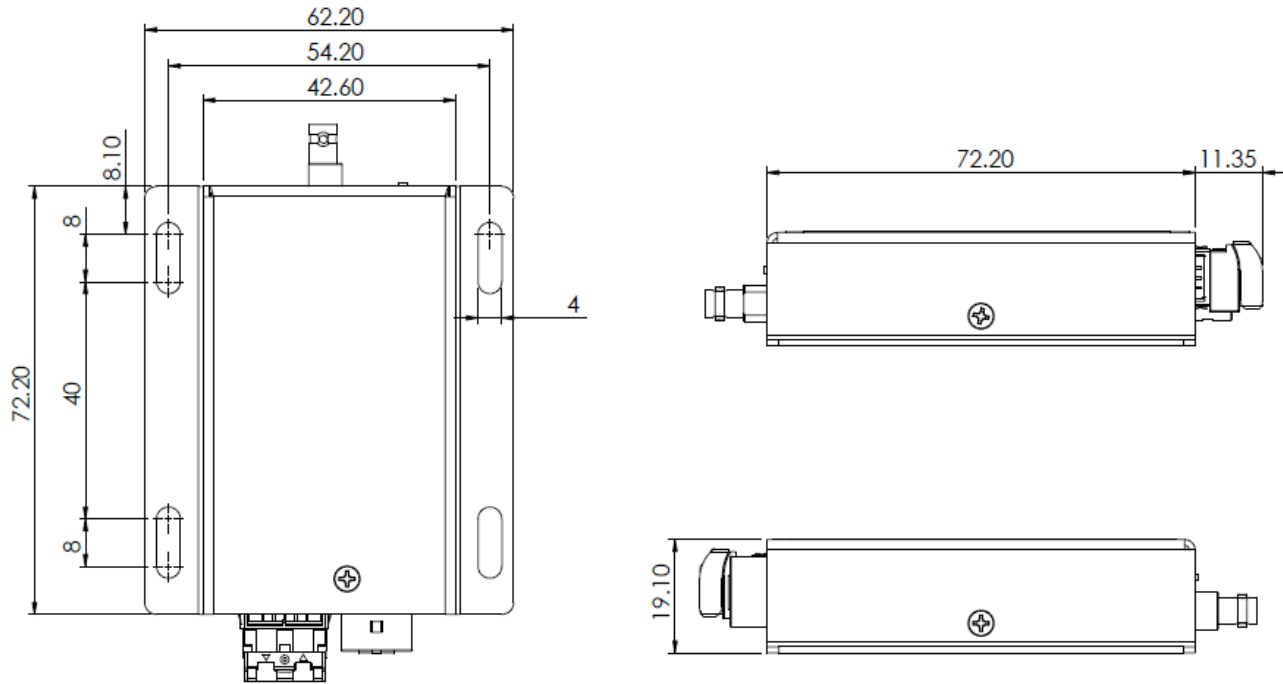

ORDERING INFORMATION

PHE1 Standard models

| Model # | Fiber Type & Estimated Link Distance * | | Fiber count | Items Provided |
|---------|--|-------------------|-------------|---|
| PHE1-M | OM3 MM | 100 m (1000 ft) | 2 | 1x PHORTE-CM 1x PHORTE-FG |
| PHE1-S | SM | 10 km (6.25 mile) | 2 | 1x 24W, DC 24V international wall mount AC/DC adapter (fiber cable not included) |
| PHE1-B | SM | 10 km (6.25 mile) | 1 | |

* Distance depending on fiber type and system design. Extra optical losses in the system will reduce the transmission distance. Longer link distance is available upon request.

Accessory

| Part # | Description |
|----------------|--|
| 618-GE24I24-BD | 24W, DC 24V international wall mount AC/DC adapter with Binder plug |
| 618-VES90-BD | 90W, DC 24V international wall mount AC/DC adapter with Binder plug |
| LC-LC-G-D-xxxM | LC to LC duplex 50/125 μ m OM3 MM fiber. xxx = desired length in meters. |
| LC-LC-S-D-xxxM | LC to LC duplex 9/125 SM fiber. xxx = desired length in meters. |



Phrontier Technologies, LLC
www.phrontier-tech.com
sales@phrontier-tech.com
Toll Free: 1-866-389-2829
Fax: 1-801-998-1855